

# FMI DIRECT DRIVE DIMENSIONS AND MOUNTING

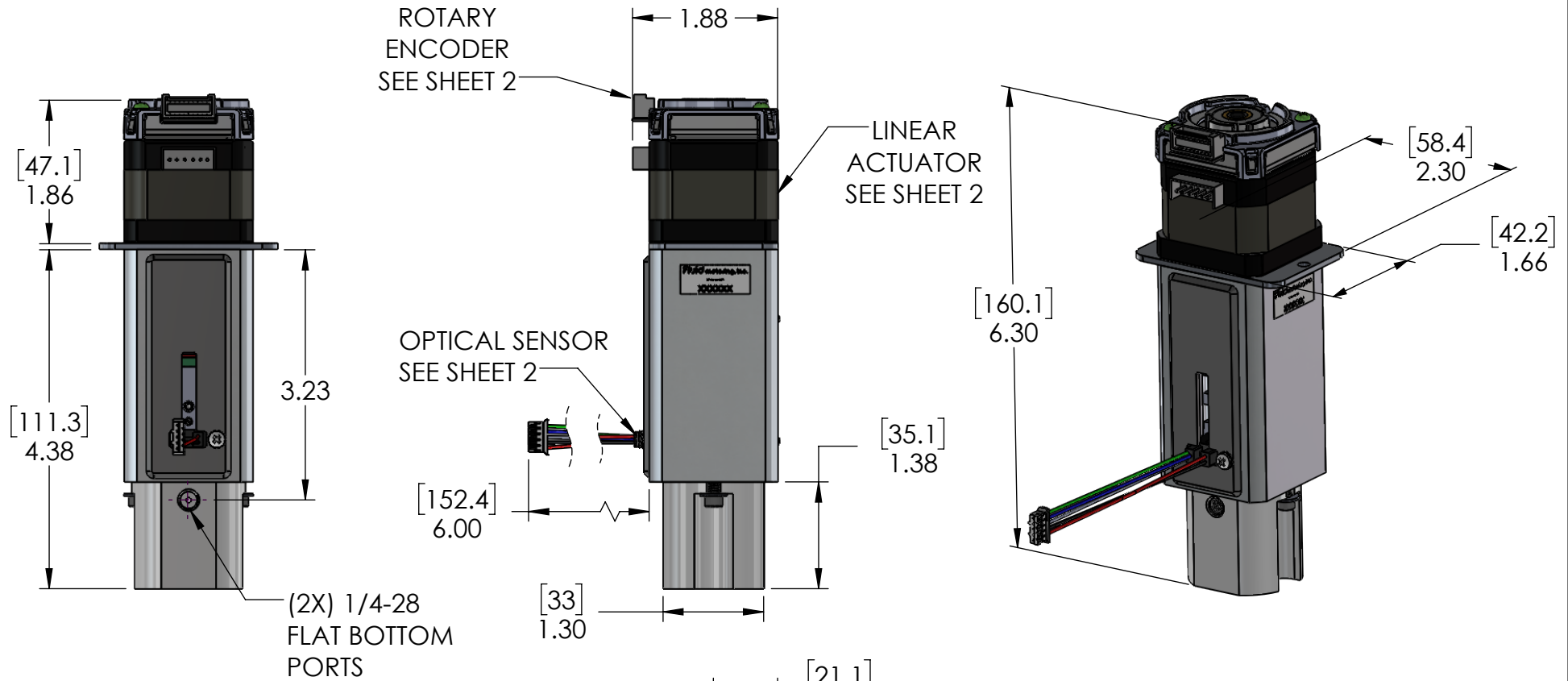

**PATENT PENDING**

**NOTICE TO PERSONS RECEIVING THIS DRAWING**

FLUID METERING INC. CLAIMS PROPRIETARY RIGHTS IN THE MATERIAL DISCLOSED HEREON. THIS DRAWING IS LOANED IN CONFIDENCE FOR INFORMATIONAL PURPOSES ONLY AND MAY NOT BE REPRODUCED, DISTRIBUTED, SOLD, RELENT, OR USED TO MANUFACTURE ANYTHING SHOWN HEREON WITHOUT DIRECT PRIOR WRITTEN PERMISSION FROM FLUID METERING, INC. TO THE USER. THIS DRAWING IS LOANED FOR MUTUAL ASSISTANCE AND REMAINS THE PROPERTY OF FLUID METERING, INC. IT IS SUBJECT TO RECALL AT ANY TIME.

FMI P/N 400818

TOLERANCES  
UNLESS OTHERWISE SPECIFIED

.X = ±.06 [1.5]  
.XX = ±.02 [0.5]  
.XXX = ±.01 [0.25]

DO NOT SCALE

SURFACE FINISH 63

DRAWN BY	NM	DATE	01/09/23
CHECKED BY	TB	DATE	01/09/23
APPVD BY	RH	DATE	02/10/23

**Fluid metering, inc.**

5 Aerial Way, Suite 500, Syosset, NY 11791  
800.223.3388 P: 516.922.6050 F: 516.624.8261 www.fluidmetering.com

TITLE		FMI DIRECT DRIVE, 1/8"	
DWG NO.	600425	REV	A
SHT NO 1 of 4			

# ELECTRICAL SPECIFICATIONS

## MOTOR CONNECTOR

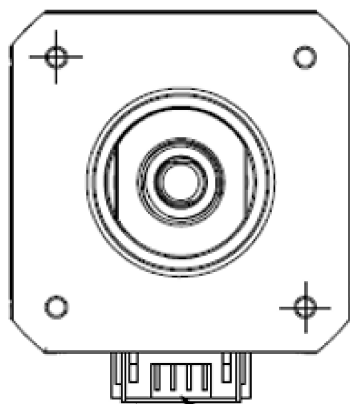

### MOTOR PINOUT TABLE

PIN #	PHASE
1	A+
3	A-
4	B-
6	B+

**MOTOR CONNECTOR:**  
JST-S6B-PH-K-S(LF)(SN)

PIN 1

## ENCODER CONNECTOR

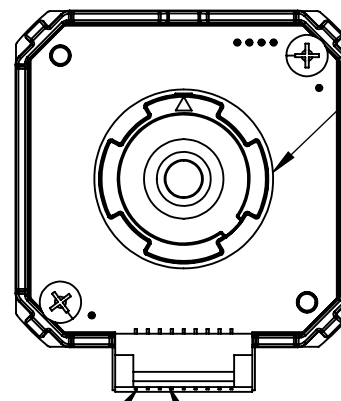

ENCODER:  
CUI  
AMT132Q-4096-1000

### ENCODER PINOUT TABLE

PIN #	DESC
1	RX_ENC+
2	TX_ENC+
4	GND
6	+5V
8	A+
9	A-
10	B+
11	B-
12	Z+
13	Z-
14	MCLR
18	NOISE GND

**ENCODER CONNECTOR:**  
JST-SM18B-ZPDSS-TF

PIN 1

## SENSOR CONNECTOR

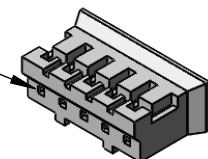

PIN 1

JST-PHR5

### MOTOR SWITCHING SEQUENCE

#### SWITCHING SEQUENCE-VIEWED FROM MOUNTING END

CCW	STEP	A	A-	B	B-
↓	1	+	-	+	-
	2	+	-	-	+
	3	-	+	-	+
	4	-	+	+	-
	1	+	-	+	-

### SENSOR WIRING TABLE

PIN #	WIRE COLOR	FUNCTION
1	GREEN	GROUND
2	BLUE	OUTPUT
3	WHITE	Vcc
4	BLACK	CATHODE
5	RED	ANODE

TOLERANCES .X = ±.06 [1.5]  
UNLESS OTHERWISE .XX = ±.02 [0.5]  
SPECIFIED .XXX = ±.01 [0.25]

DO NOT SCALE SURFACE FINISH 63

DRAWN BY NM DATE 01/09/23

CHECKED BY TB DATE 01/09/23

APPVD BY RH DATE 02/10/23

FMI P/N 400818

**fluid metering, inc.**

5 Aerial Way, Suite 500, Syosset, NY 11791  
800.223.3388 P: 516.922.6050 F: 516.624.8261 www.fluidmetering.com

TITLE  
FMI DIRECT DRIVE,  
1/8"

DWG NO.  
600425

REV  
A

SHT NO 2 of 4

# CABLE SPECIFICATIONS

## MOTOR CABLE

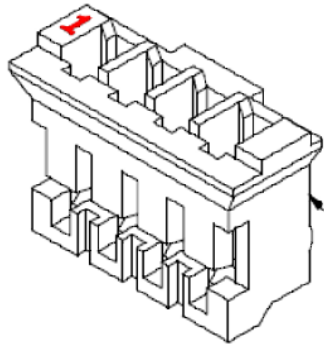
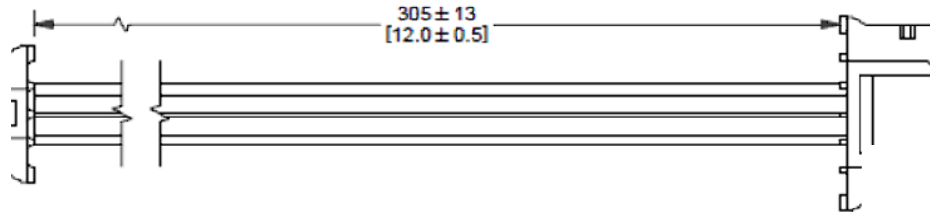

**CONNECTOR:**  
JST PHR-4  
**PINS:**  
ACCEPTABLE IN  
JST SPH-002T-P0.5S  
LOOSE OR REEL  
PACKAGING

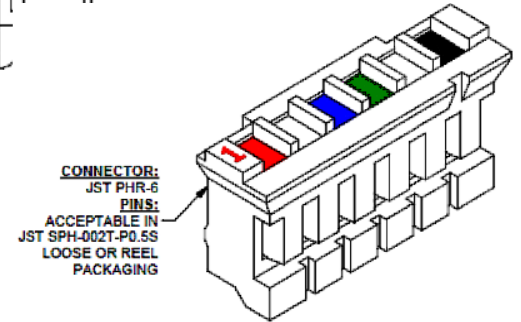

**CONNECTOR:**  
JST PHR-6  
**PINS:**  
ACCEPTABLE IN  
JST SPH-002T-P0.5S  
LOOSE OR REEL  
PACKAGING

## ENCODER CABLE

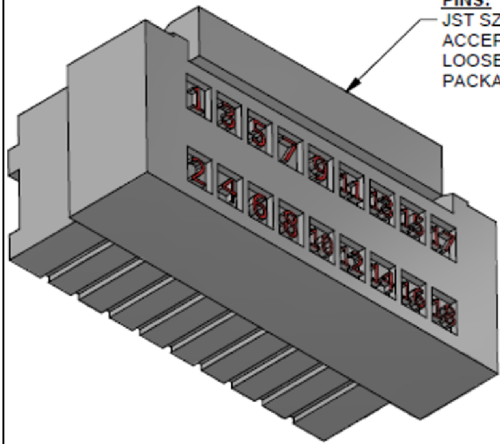
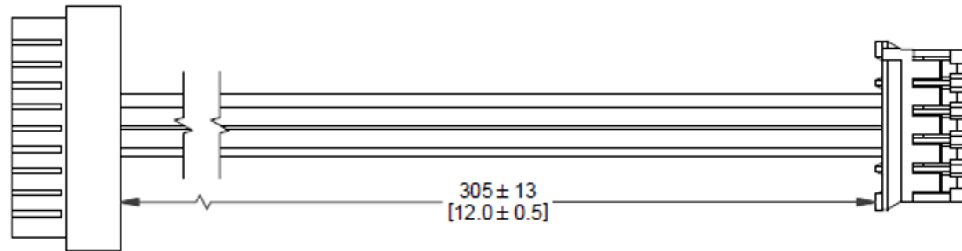

**CONNECTOR:**  
JST ZPDR-18V-S  
**PINS:**  
JST SZPD-002T-P0.3  
ACCEPTABLE IN  
LOOSE OR REEL  
PACKAGING

FMI P/N 400818

**NOTES:**

1. ENCODER CABLE FOR SINGLE ENDED CONFIGURATION.

TOLERANCES UNLESS OTHERWISE SPECIFIED		.X = ±.06 [1.5] .XX = ±.02 [0.5] .XXX = ±.01 [0.25]				5 Aerial Way, Suite 500, Syosset, NY 11791 800.223.3388 P: 516.922.6050 F: 516.624.8261 www.fluidmetering.com		
DO NOT SCALE		SURFACE FINISH				TITLE		
DRAWN BY	NM	DATE	01/09/23	FMI DIRECT DRIVE, 1/8"				
CHECKED BY	TB	DATE	01/09/23					
APPVD BY	RH	DATE	02/10/23	DWG NO.	600425	REV	A	SHT NO 3 of 4

# PUMP PERFORMANCE AND SPECIFICATIONS

## PUMP VOLUMETRIC PERFORMANCE

VOLUME RESOLUTION		.031 $\mu$ L / FULL STEP	
VOLUME	STEP COUNT	ACCURACY	PRECISION
1 $\mu$ L (TYPICAL)	31.5	< $\pm$ 2%	< 1%
3 $\mu$ L	94.5	$\leq$ $\pm$ 2%	$\leq$ 1%
150 $\mu$ L (FULL STROKE)	4725	$\leq$ $\pm$ 0.1%	$\leq$ 0.1%

## OPERATING SPECIFICATIONS

PISTON SIZE	1/8"
DIPSENSE/ASPIRATE RESOLUTION	.031 $\mu$ L / FULL STEP
MAX TRAVEL FROM HOME	5200 STEPS
MAX OPERATING PRESSURE	100 PSI
MAX FLUID TEMPERATURE	100 $^{\circ}$ F
MIN FLOW RATE	0.105 $\mu$ L/s @ 1 RPM
MAX FLOW RATE	62.8 $\mu$ L/s @ 600 RPM
LIFE EXPECTANCY	> 1 MILLION CYCLES

\* MAX SPEED BASED ON MOTOR DRIVER

## DRIVE SPECIFICATIONS

RATED CURRENT	1.5AMP/PHASE
MOTOR FRAME	NEMA 17
STEP ANGLE	1.8 $^{\circ}$
MAX SPEED	2000 STEP/S*
MOTOR CW	ASPIRATE
MOTOR CCW	DISPENSE

## GENERAL INFORMATION

FLUID PATH MATERIALS	CERAMIC (ZIRCONIA) PVDF   UHMW-PE   FKM
SEAL MATERIALS	UHMW-PE   FKM
CERTIFICATIONS	REACH   RoHS
WEIGHT	1.3 LBS

FMI P/N 400818

TOLERANCES  
UNLESS OTHERWISE SPECIFIED  
 .X =  $\pm$ 0.06 [1.5]  
 .XX =  $\pm$ 0.02 [0.5]  
 .XXX =  $\pm$ 0.01 [0.25]

DO NOT SCALE

SURFACE FINISH  $\sqrt{63}$

**fluid metering, inc.**

5 Aerial Way, Suite 500, Syosset, NY 11791  
 800.223.3388 P: 516.922.6050 F: 516.624.8261 www.fluidmetering.com

DRAWN BY	NM	DATE	01/09/23
----------	----	------	----------

CHECKED BY	TB	DATE	01/09/23
------------	----	------	----------

APPVD BY	RH	DATE	02/10/23
----------	----	------	----------

TITLE

FMI DIRECT DRIVE,  
1/8"

DWG NO.	600425
---------	--------

REV	A
-----	---

SHT NO 4 of 4